

GC4 Weatherproof Padlockable Paddle Hook Latch

Features

- Weatherproof, lightweight, and acoustically 'quiet'
- Padlock can be fitted to provide visible evidence that the enclosure is securely locked
- Stainless steel loop striker ensures positive engagement to resist vibration
- Moulded case with integral gasket and no rear apertures prevents entry of water
- Moulded 'ramp' on hook provides exceptionally smooth action
- Fits same aperture as our standard rectangular 'paddle' latches
- Close door so that ramped face of hook meets striker and is forced to engage. Once shut, turn die cast knob through 90° to secure flap against base, then depress top and insert padlock through aperture. The flap now cannot open.
- Locking with padlock prevents movement of flap but hook is still free to operate and will slam-shut

Material

- Case and flap: Glass-filled nylon, black lightly textured finish
- Steel components are zinc plated for corrosion resistance

Notes

- Fixed with two M8 stainless bolts and steel 'U'-bracket which clamps paddle against underside of panel
- Special models include an extended 'hook' (dimension 'F' = 50 mm) which offers greater depth of penetration (see illustration)
- Stainless steel loop striker (**G00406**) sold separately



GC4-G05462-PL

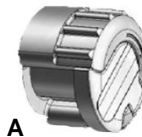

A

View A shows knob in 'rest' position

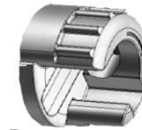

B

View B shows the top section retracted to allow entry of padlock shackle

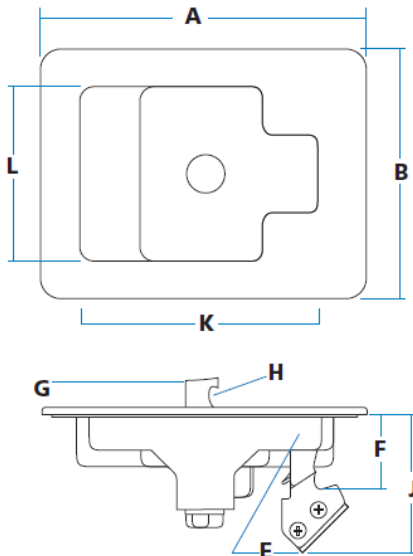

Striker made in 6 mm diameter stainless rod, welded to stainless back-plate. Alternatively it can be supplied without bend (M = 80 mm) as **G00406-02**



Contact Gripwell sales for special 50 mm extended hook model

Part No.	A	B	E	F	G	H	J	K	L	M	N	O	P	R
GC4-G05462-PL	140	108	30	32*	15	6.5	59	111	81	48	40	7	55	31

*For special 50 mm extended hook model, F dimension is 50